

## PRODUCT SPECIFICATIONS

### Wall Accessory Cabinets - Wall Open Cabinet Microwave Shelf Insert

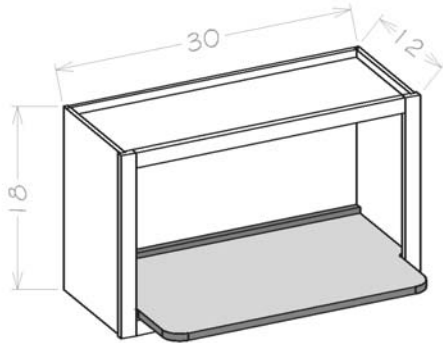

Model	Description	Width	Height	Depth
WMSSHELF	Installed Shelf Dimension	26½	¾	17

### Wall Accessory Cabinets - Wall Open Cabinet - X Rack Insert

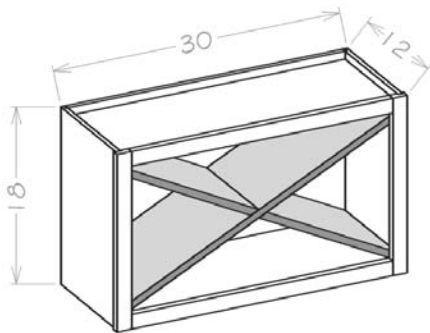

Model	Description	Width	Height	Depth
WXRSHELF	Installed Shelf Dimension	26½	14½	11

### Wall Accessory Cabinets - Wall Microwave Cabinet Kits

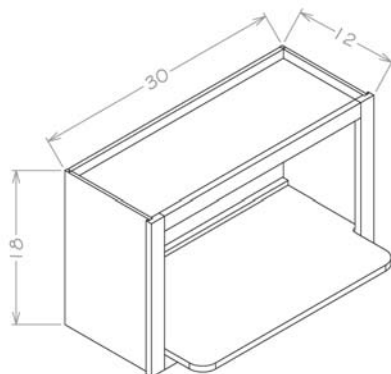

Model	Description	Width	Height	Depth
WMS3018	Cabinet Dimension	30	18	12
	Shelf Dimension	26½	¾	17

- Two boxes will be received when ordering this cabinet kit flat pack.